

Dorado Drain Paver



Installation

FULL EXFILTRATION

- 1 Dorado Drain Paver
- 2 Joint filling material ASTM No 8 (CSA 2.5-10mm) aggregate
- 3 Bedding course 1 1/5" to 2" (40 to 50 mm) ASTM No 8 (CSA 2.5-10mm) aggregate
- 4 Base course 4" (100mm) ASTM No 57 (CSA 5-28mm) aggregate foundation thickness
- 5 Subbase course ASTM No 2 (CSA 40-80mm) aggregate
- 6 Geotextile (optional)
- 7 Subgrade
- 8 Concrete Edge

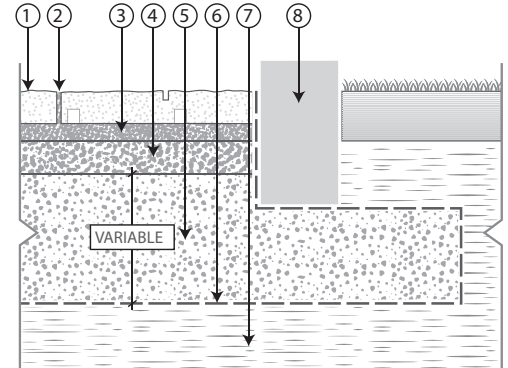

SINGLE COLOURS



Natural Grey



Charcoal



Sierra Beige

Sizes

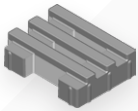

9" x 12" x 3-1/8"
228mm x 304mm x 80mm
Including 3 mm Spacer Bars
Area: 1.3 stones/ft² – 14.35 stones/m²

Specifications

WEIGHT

3-1/8 (80 mm): approx. 23.8 lbs/ft² (120kg/m²)

PARTIAL EXFILTRATION

- 1 Dorado Drain Paver
- 2 Joint filling material ASTM No 8 (CSA 2.5-10mm) aggregate
- 3 Bedding course 1 1/5" to 2" (40 to 50 mm) ASTM No 8 (CSA 2.5-10mm) aggregate
- 4 Base course 4" (100mm) ASTM No 57 (CSA 5-28mm) aggregate foundation thickness
- 5 Subbase course ASTM No 2 (CSA 40-80mm) aggregate
- 6 Geotextile (optional)
- 7 Subgrade
- 8 Concrete Edge
- 9 Perforated drain connected to drainage system

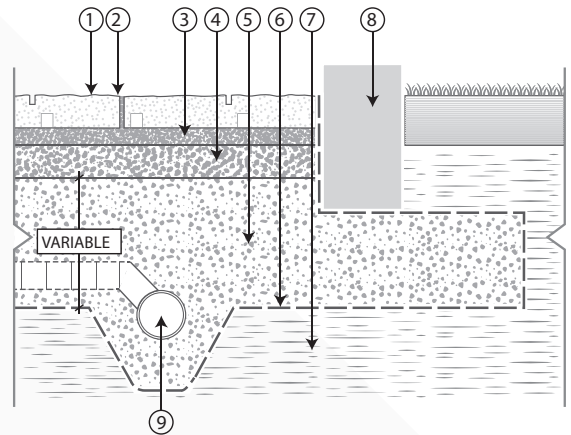

NO EXFILTRATION

- 1 Dorado Drain Paver
- 2 Joint filling material ASTM No 8 (CSA 2.5-10mm) aggregate
- 3 Bedding course 1 1/5" to 2" (40 to 50 mm) ASTM No 8 (CSA 2.5-10mm) aggregate
- 4 Base course 4" (100mm) ASTM No 57 (CSA 5-28mm) aggregate foundation thickness
- 5 Subbase course ASTM No 2 (CSA 40-80mm) aggregate
- 6 Geotextile (optional)
- 7 Subgrade
- 8 Concrete Edge
- 9 Perforated drain connected to drainage system
- 10 Impermeable membrane

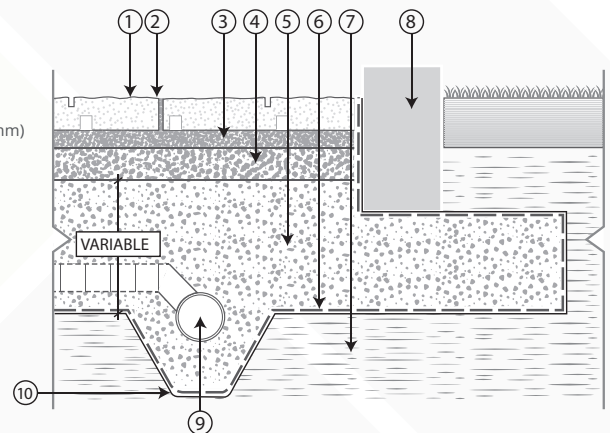

RECOMMENDED APPLICATIONS



Permeable Paver



Walkways



Residential Driveway/Parking